

DIN STANDARD CONNECTIONS

# M22010

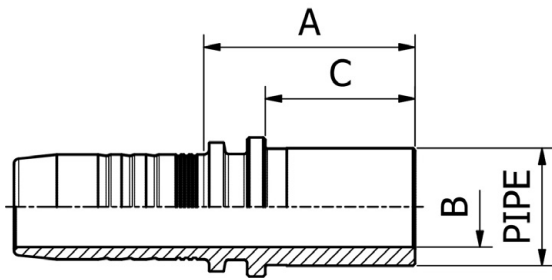

METRIC STANDPIPE LIGHT DUTY  
DIN 2353 / ISO 8434-1

PART. REF.	HOSE BORE			Pipe	DIMENSIONS mm							
	DN	Dash	inch		mm	B	A	C				
M22010-03-04	5	- 3	3/16"	4.0		2.0	29.5	22.0				
M22010-03-06	5	- 3	3/16"	6.0		3.0	29.5	22.0				
M22010-04-06	6	- 4	1/4"	6.0		3.0	30.0	22.0				
M22010-05-08	8	- 5	5/16"	8.0		5.5	30.0	22.0				
M22010-05-10	8	- 5	5/16"	10.0		7.0	31.0	23.0				
M22010-06-10	10	- 6	3/8"	10.0		7.0	31.5	23.0				
M22010-06-12	10	- 6	3/8"	12.0		8.0	31.5	23.0				
M22010-06-15	10	- 6	3/8"	15.0		10.5	33.5	25.0				
M22010-08-12	12	- 8	1/2"	12.0		8.0	32.0	23.0				
M22010-08-15	12	- 8	1/2"	15.0		10.5	34.0	25.0				
M22010-08-18	12	- 8	1/2"	18.0		12.5	35.0	26.0				
M22010-10-18	16	- 10	5/8"	18.0		12.5	35.0	26.0				
M22010-10-22	16	- 10	5/8"	22.0		15.0	37.0	28.0				
M22010-12-18	19	- 12	3/4"	18.0		12.5	36.5	26.0				
M22010-12-22	19	- 12	3/4"	22.0		15.0	38.5	28.0				
M22010-16-28	25	- 16	1"	28.0		19.8	41.5	30.0				
M22010-20-35	31	- 20	1.1/4"	35.0		26.0	48.5	36.0				
M22010-24-42	38	- 24	1.1/2"	42.0		32.0	52.5	40.0				

DIN STANDARD CONNECTIONS

# M22110

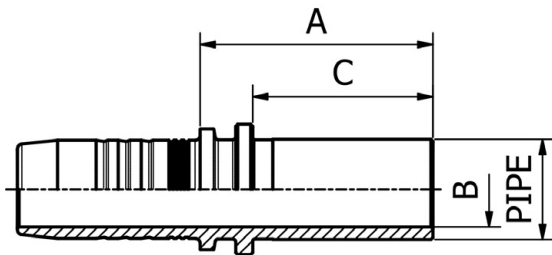

METRIC STANDPIPE HEAVY DUTY  
DIN 2353 / ISO 8434-1

PART. REF.	HOSE BORE			Pipe	DIMENSIONS mm							
	DN	Dash	inch		mm	B	A	C				
M22110-03-08	5	- 3	3/16"	8.0		3.0	31.0	24.0				
M22110-03-10	5	- 3	3/16"	10.0		3.0	29.5	22.0				
M22110-04-08	6	- 4	1/4"	8.0		4.0	32.0	24.0				
M22110-04-10	6	- 4	1/4"	10.0		4.0	34.0	26.0				
M22110-04-12	6	- 4	1/4"	12.0		7.0	34.0	26.0				
M22110-05-12	8	- 5	5/16"	12.0		7.0	34.0	26.0				
M22110-06-14	10	- 6	3/8"	14.0		8.0	37.5	29.0				
M22110-08-14	12	- 8	1/2"	14.0		9.3	38.0	29.0				
M22110-08-16	12	- 8	1/2"	16.0		10.5	39.0	30.0				
M22110-10-20	16	- 10	5/8"	20.0		12.5	45.0	36.0				
M22110-12-20	19	- 12	3/4"	20.0		15.0	46.5	36.0				
M22110-12-25	19	- 12	3/4"	25.0		15.0	50.5	40.0				
M22110-16-25	25	- 16	1"	25.0		15.0	51.5	40.0				
M22110-16-30	25	- 16	1"	30.0		19.8	55.5	44.0				
M22110-16-38	25	- 16	1"	38.0		26.0	61.5	50.0				
M22110-20-30	31	- 20	1.1/4"	30.0		20.5	56.5	44.0				
M22110-20-38	31	- 20	1.1/4"	38.0		26.0	62.5	50.0				
M22110-24-38	38	- 24	1.1/2"	38.0		26.0	62.5	50.0				